

估價圖面
樣品圖面
參考圖面
承認圖面
更新圖面

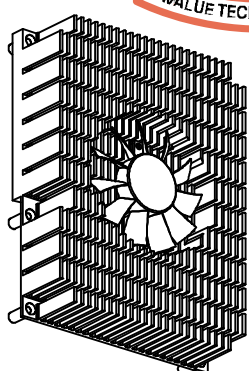

REV.	DATE	REMARK	DESIGNED	APPROVED

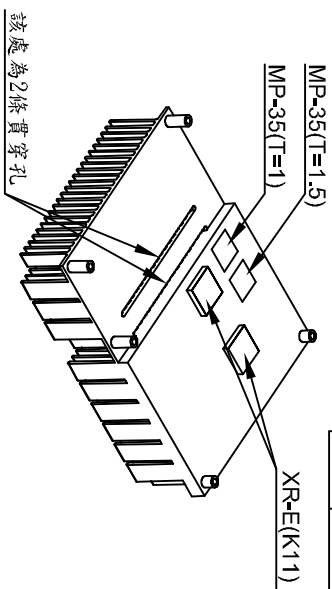
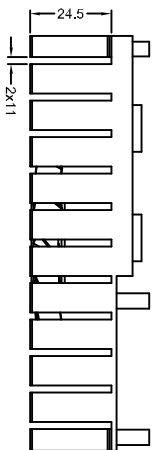
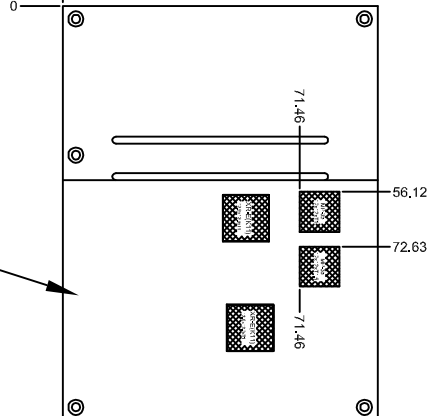
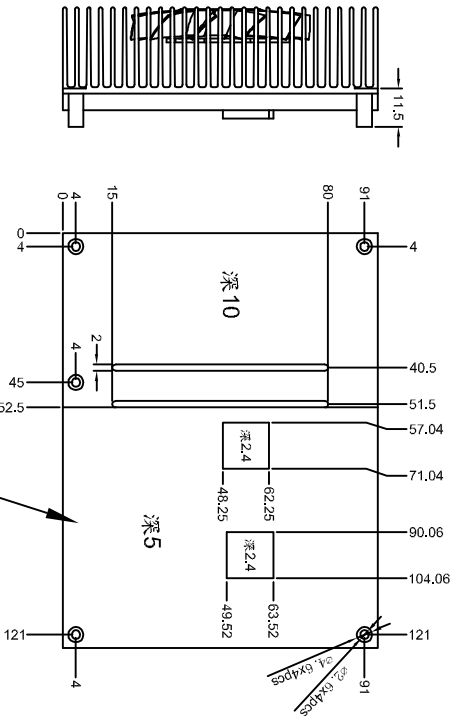
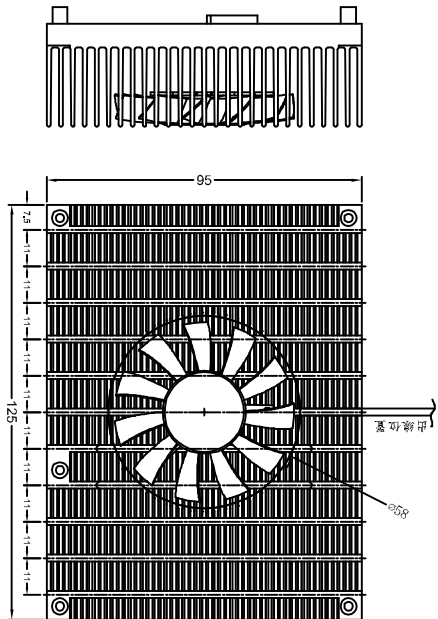

底部CNC加工深度示意圖

底部PAD貼合位置示意圖

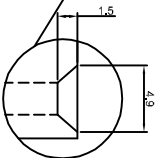
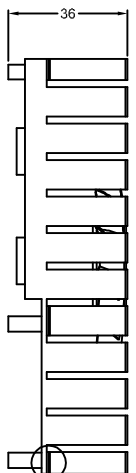

- 1、標註數值皆為要切除之部份
- 2、貼PAD的位置圖
- 3、配合螺絲：E1931011600R(5pcs)
- 4、5支圓柱為CNC一體成型,上方需做倒C角處理
- 5、需組裝風扇,風扇外徑為 $\phi 55\text{mm}$,高10mm,風扇出線長200mm

GENERAL TOL.		A	B	MATERIAL: AL 6063		PART No. E1961254901R		NAME Heat sink AL-FAN H=36mm ESM-A50M BGA	
TOL.		A	B	SPEC.:		DWG No. E1961254901R-A1		MODEL No. ESM-A50M	
>0		± 0.1	± 0.1	FINISH: 陽極本色		APPROVED		DRAWN	
>10		± 0.1	± 0.2	UNIT: MM		CHECKED		REV. A1	
>50		± 0.15	± 0.3	SCALE: 1/1		DESIGNED		SHEET: 1 / 1	
>200		± 0.3	± 0.5	UNIT: MM		DRAWN		AX	
>500		± 0.5	± 0.8	SCALE: 1/1		REV. A1		AX	



此符號,則代表零件之重點尺寸
若無符號,則代表零件之次要尺寸